

C 15-4-145

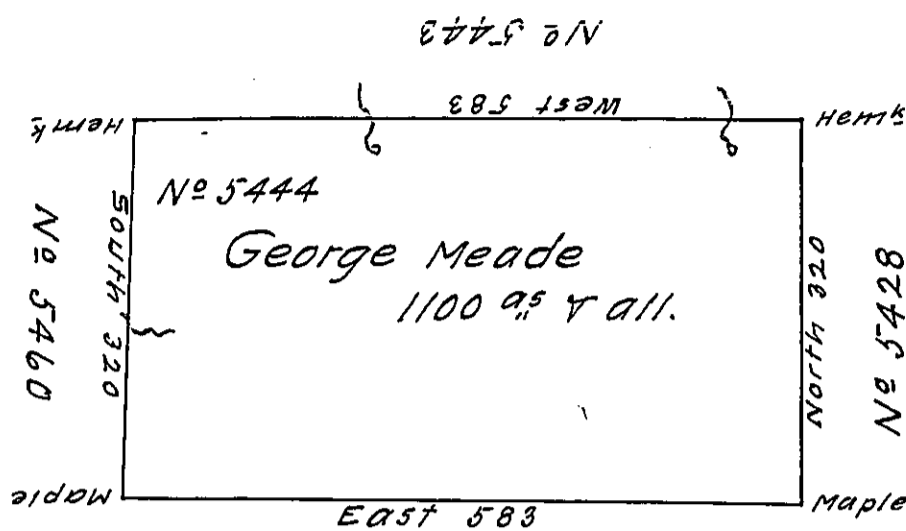

a 64-36

a 46-35

No 5445
a 83-36

Situate on the waters of Sinnemahoning Creek in North^d County containing 1100 acres and the usual allowance for roads. Surveyed May 14th 1794 for George Meade in pursuance of a warrant No 5444 dated 3^d March 1794

John Canan D.S.

Daniel Brodhead Esq^t S.G.

IN TESTIMONY that the above is a copy of the original remaining on file in the Department of Internal Affairs of Pennsylvania, made conformably to an Act of Assembly approved the 16th day of February, 1833, I have hereunto set my Hand and caused the Seal of said Department to be affixed at Harrisburg, this seventh day of February 1912

Henry Howard
Secretary of Internal Affairs.